



Installation Guide

celexon screen electric economy



Please read the installation instructions carefully
before using the screen. Please keep for future reference.

Please read these important safety instructions

- Read and understand all instructions before installing and using the projection screen.
- Close supervision is necessary when Projection screen is in use by or near children. Do not leave Screen unattended while is use.
- Installer must ensure that the mounting structures and fasteners must be of adequate strength to securely support the screen so that vibrations or even abusive pulling on the screen surface will not cause the housing to work loose or fall.
- Do no operate screen with a damaged cord or if the screen has been dropped or damaged until it has been examined and repaired by a qualified serviceman.
- DO NOT place or attach anything to metal casing or viewing surface of the screen.
- Position cord so that it will not be tripped over ,pulled or in contact with hot surfaces.
- DO NOT plug the cord with wet hands; electric shock could occur.
- DO NOT under any circumstances cut or removed the third (Ground) Prong from the power cord. For personal safety , this projection Screen must be properly grounded.
- Always unplug Projection screen from electrical outlet before cleaning and servicing and when not in use. Never Yank cord to pull cord from outlet. Grasp cord and pull to disconnect.
- To reduce the risk of electric shock , do not disassemble this Projection screen , but take it to a qualified servicemen when Service or repair is required. Incorrect reassembly can result in electric shock when used.

Cord and Plug Installations Safety Instructions:

- The length of power cord used in this Projection Screen was selected to reduce the hazards of anyone becoming tangled or tripping over it .
- We strongly recommend against the use of an extension cord .
- If an extension cord is necessary , it is absolutely necessary that it is UL-Listed , 3-wire grounding type appliance extension cord having a grounding type plug and outlet. The electrical rating of the extension cord must be equal or greater than the rating of the projection screen.
- Always unplug Projection Screen from electrical outlet before cleaning and servicing and when not in use . Never Yank cord to pull cord from outlet. Grasp cord and pull to disconnect.
- Always connect this projection Screen to a grounded outlet. Outlet-Socket should be located near the Screen and shall be easily accessible.

Electrical spec

Voltage: 100V – 120V, 60Hz
or 220V – 240V, 50Hz

Power consumption: 130W (max),
0.4W (standby)

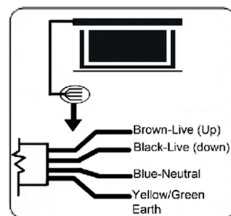

Installation

Install the screen so that it is central for most viewers. When fully extended, please ensure that the lower third is at about eye level with the intended viewer. The screen can be wall or ceiling mounted by screws or it can be fixed via hanging hooks from the ceiling (hooks are supplied).

You will be required to purchase screws/wall plugs suitable for your specific wall/ceiling material. For mounting on a wooden surface, we suggest to use $\varnothing 4 \times 50$ mm wood screws, for mounting on a brick/concrete surface, we suggest to use $\varnothing 6 \times 50$ mm screws/wall plugs.

Ceiling installation (via hanging hooks):

Attach the hooks to both end caps and measure the distance between the hooks. Mark out the positions on the ceiling and drill holes for the hooks ensuring that hooks and holes are aligned. Hang up the screen.

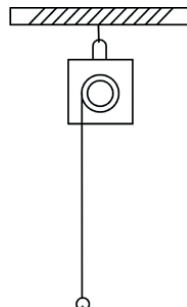
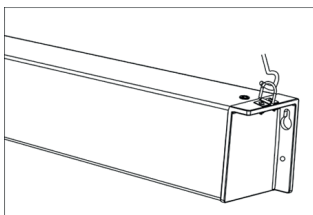
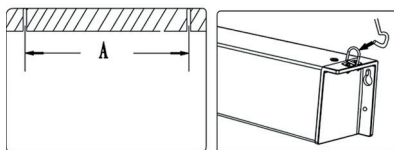
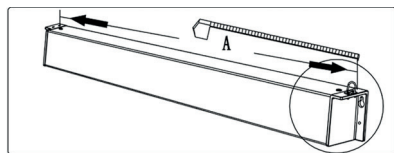

Installation

Ceiling installation (screwed):

Measure the distance of the holes on the end caps (2 on each side) and mark out same distance on the ceiling. Ensure that they are aligned and drill holes. Use suitable screws with wall plugs and screw the screen to the ceiling.

PLEASE NOTE: Do not over tighten the screws. If cracks appear in the end caps, they must be replaced. Do not use the screen.

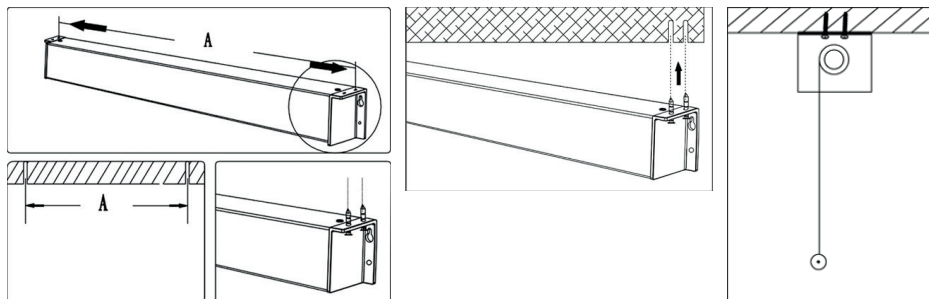

Wall installation (unscrew hooks if desired):

Measure the distance of the holes on the end caps and mark out on the wall. Ensure that they are aligned. Prepare suitable screws with wall plugs for your wall. Screw the two top screws into the wall up to 1 cm and hang the screen on each side in the upper hole. Check with a spirit level that it is level. Tighten the top and bottom screws.

PLEASE NOTE: do not over tighten the screws. If cracks appear in the end caps, they must be replaced. Do not use the screen.

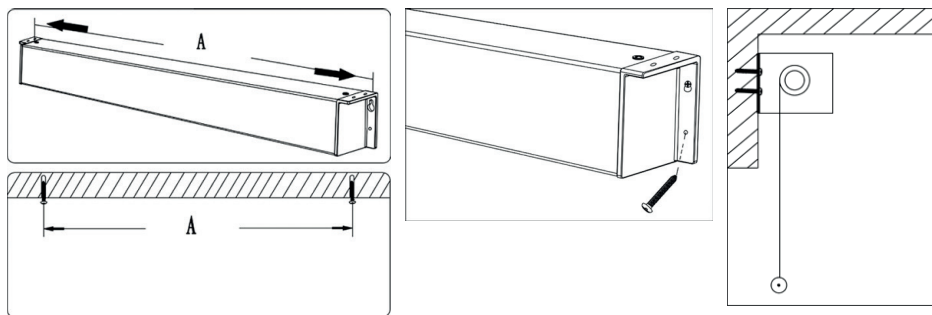

Operating the screen via wall switch (see fig. 1)

Plug power cable into socket (ensure correct voltage). Position the cable so that it does not present a hazard or comes into contact with any hot surface. You may require an extension lead. The wall switch must be mounted so that the cable outlet is at the bottom.

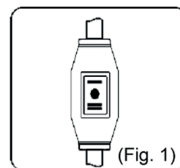

To lower the screen (see fig 2)

Press the down arrow button. The screen will come down and stop automatically at its default stop position.

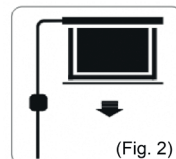

To retract the screen (see fig 3)

Press the up arrow button. The screen will automatically retract into its housing and stop at the upper default stop position.

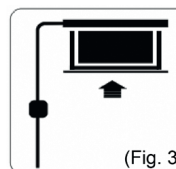

To stop the screen

Press the stop button (between the arrows) and the screen will automatically stop.

Wireless operation (infra red) (see fig 4)

Plug power cable into socket (ensure correct voltage). Position the cable so that it does not present a hazard or comes into contact with any hot surface. You may require an extension lead. The wall switch must be mounted so that the cable outlet is at the bottom.

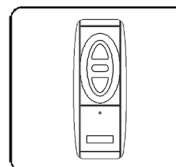

To lower the screen

Press the lower button on the remote control and the screen will automatically lower itself and stop at the default stop position.

To retract the screen

Press the top button on the remote control and the screen will automatically retract into its housing and stop when fully retracted.

To stop the screen manually

Press the middle button on the remote control and the screen will stop.

It is possible to adjust the stop positions.

Please contact your dealer or email info@celexon.co.uk for written instructions.

EC declaration of conformity,

Manufacturer: celexon Germany GmbH & Co. KG
Address: Gutenbergstraße 2, 48282 Emsdetten, DE

hereby declares that the following product

Product name: celexon screen electric economy
Manufacturer: celexon Germany GmbH & Co. KG,
48282 Emsdetten, DE

complies with the following standards:

89/336/EEC

93/68/EEC

EN 55014-1: 2000 + A1: 2001 + A2: 2002

EN 61000-3-2 : 2000 + A2: 2005

EN 610000-3-3 : 1995 + A1 : 2001

EN 55014-2 : 1997 + A1 : 2001

Notes:

The tests were carried out in normal mode and refer to the tested device under the specified tests. This certificate applies only to the devices tested.

Emsdetten, den 10.10.2013



Christoph Hertz
Managing Director



celexonTM 

www.celexon.com

